



US Army Corps
of Engineers
Alaska District

Public Notice of Application for Permit

Regulatory Division (1145)
CEPOA-RD
Post Office Box 6898
JBER, Alaska 99506-0898

PUBLIC NOTICE DATE: February 24, 2015
EXPIRATION DATE: March 10, 2015
REFERENCE NUMBER: POA-2014-436
WATERWAY: Zimovia Strait

PUBLIC NOTICE REVISION

On November 6, 2014, the Alaska District Corps of Engineers published a Public Notice for a Department of the Army (DA) permit application, POA-2014-436, Zimovia Strait, to discharge 920 cubic yards of shot rock below the high tide line (HTL) of Zimovia Strait, to construct a 30 feet by 80 feet (0.06-acre) house pad. The project site is located within Section 24, T. 62 S., R. 83 E., Copper River Meridian, USGS Quad Map: Petersburg B-2, Latitude 56.4734° N., Longitude 132.3897° W., 231 Stikine Avenue, Lot 6, in Wrangell, Alaska.

The applicant has submitted revised plans, reducing the volume of shot rock to be discharged below the HTL from 920 cubic yards to 360 cubic yards, and reducing the fill pad from 30 feet by 80 feet (0.06-acre) to 30 feet by 30 feet (0.02-acre). Additional work includes: constructing a 20 feet by 25 feet pile supported deck, a 10 feet by 30 feet pile supported ramp, and a 20 feet by 20 feet pile supported platform. All piles would be 5 inch diameter galvanized steel, and the height of the pile supported structures would be +23 feet (MLLW) to minimize view obstructions.

As compensation for aquatic resource impacts, the applicant is no longer proposing to transplant sea grass located within the intertidal area on his property. Rather, the proposed compensatory mitigation is proposed to be accomplished through a fee-in-lieu payment.

All other information contained in the previous notice remains the same. Please bring this announcement to the attention of anyone you know who is or may be interested. Please contact Jack Hewitt at (907) 753-2708, toll free from within Alaska at (800) 478-2712, by fax at (907) 753-2708, or by email at jack.j.hewitt@usace.army.mil if further information is desired concerning this notice.

District Engineer
U.S. Army, Corps of Engineers

N
Adjacent owner
Tim Peterman

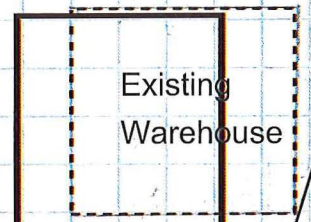

HTL +19.8

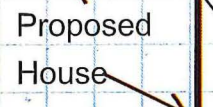

Adjacent owner
Thielmann

Foundation wall

Existing
Fill

Existing
Stacked wall

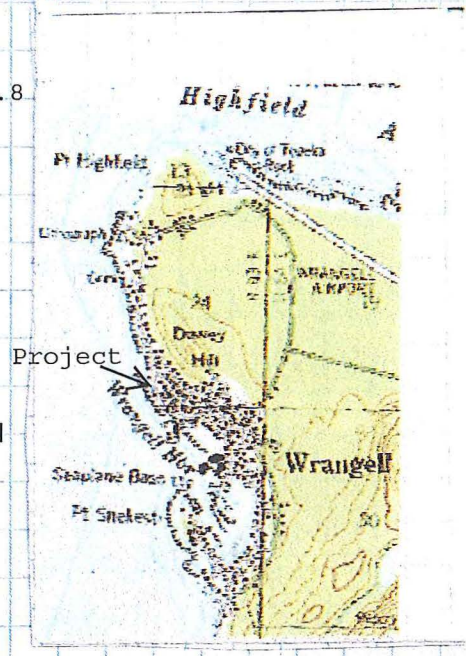

HTL
MHW

Top of fill
+23

+13 tide

Sea Grass

174'

101'

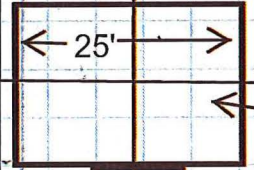

Proposed
Fill 30'x30'

Piling Supported deck
Elevation +23
25'x20'



Piling Supported Ramp
Elevation +23
10'x30'

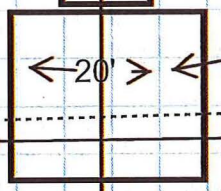

Piling Supported platform
Elevation +23
20'x20'

+8' tide

30'

Scale
1"=20'

MLLW



Rock Fill Lot 6 BLK A
for Residence buildings
POA-2014-359 Revised
1/5/2015
Zimovia Strait
September 2014
Sheet 1 of 2

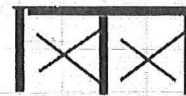
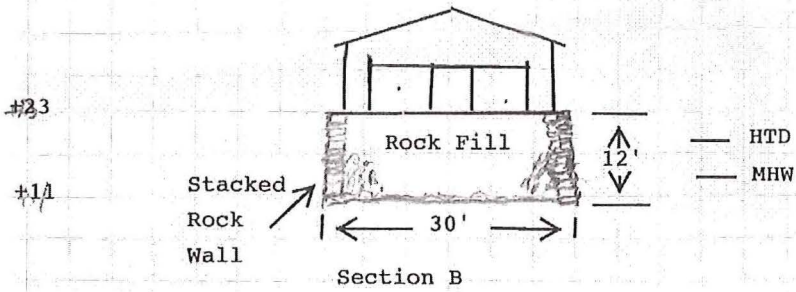
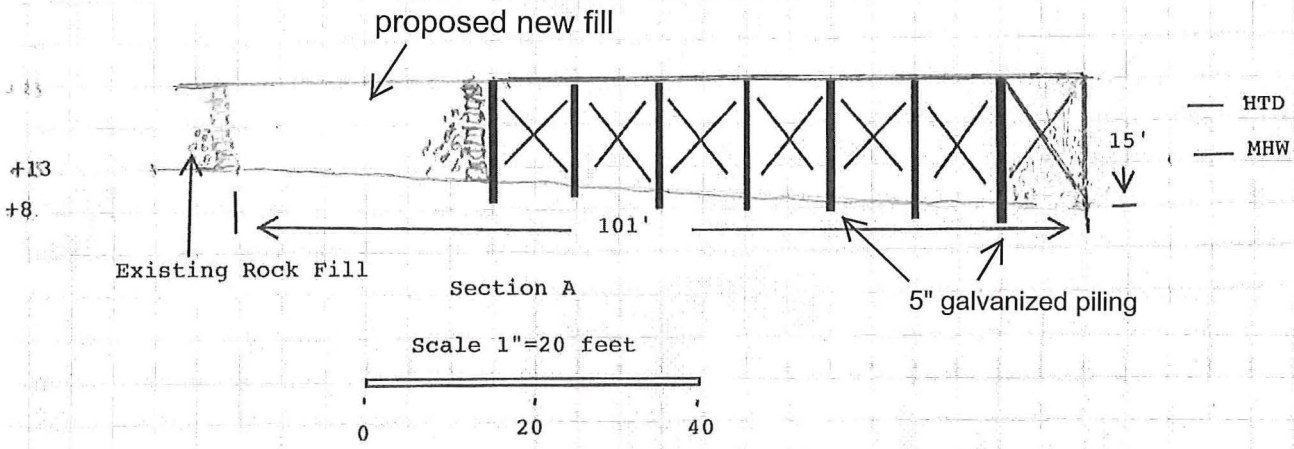

Section C
Deck

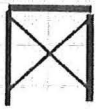

Section D
Ramp

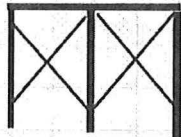

Section E
Platform

Rock Fill Lot 6 BLK A
 Revised 1/5/15
 For Residence Buildings
 Zimovia Strait
 September 2014
 Sheet 2 of 2
 POA-2014-436